

SECTION 5
FLUID HANDLING ACCESSORIES



Table of Contents

Recirculating DI Water Spray Gun and Kit.....	430
Spray Gun	432
Nitrogen Spray Gun	433
Spray Nozzles	434
Custom Coiled Tubing.....	436
In-line Filters	437
Fasteners	440

Recirculating DI Water Spray Gun and Kit

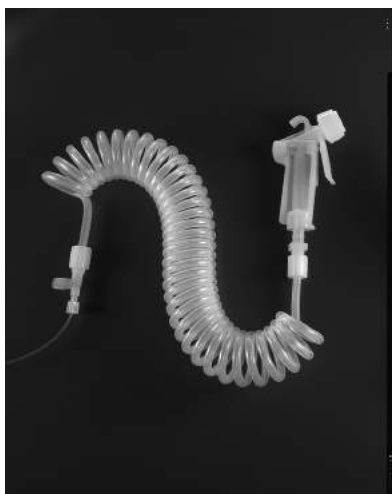

Part Number (DI Water Gun Only)

421 - 1X1 - 1

Cap Color
1 = Natural

Type of Inlet Connection
1 = 3/8" Flaretek® tube fitting
2 = PVC Hose

See page 432 for NPT connections.

Spray Gun Kits

Part* Number	Description
421-66	Spray gun with PFA recirculation kit
421-65	Spray gun with FEP recirculation kit

*The complete assembly comes ready for installation and includes:
DI water spray gun with 3/8" Flaretek® tube fitting connection,
3/8" coiled tubing (stretches to 8 ft. long),
1/8" recirculating tubing and the unique Flaretek® tube fitting
recirculating tee (3/8" Flaretek® x 1/4" NPT x 1/8" integral ferrule, as pictured).

Specifications (Gun Only)

Maximum pressure:	80 PSIG (552 kPa)
Orifice:	3/16" (4.8 mm)
Connection:	3/8" Flaretek® tube fitting
Materials:	All wetted parts are high purity PFA.

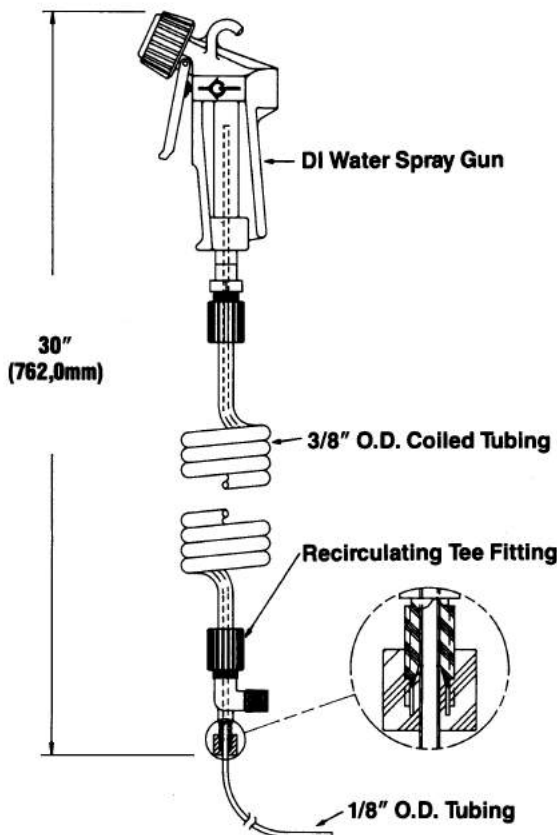

Recirculating DI Water Spray Gun and Kit

Accessories for DI Water Spray Gun

Part Number	Description
215-128	Recirculating tee fitting (3/8" Flaretek® tube fitting × 1/4" MNPT × 1/8" compression)
215-138	Recirculating tee fitting (3/8" Flaretek® tube fitting × 1/8" compression)
215-129	Recirculating tee fitting For use on 1/2" PVC Hose (1/2" compression × 1/4" NPT × 1/8" compression)
221-62	Recirculating kit for PVC hose includes, Tee Fitting (215-129), 10 feet FEP 1/8" Tubing (ET125-030)
221-59	Coiled 3/8" O.D. FEP tubing (stretches to 8 ft. long, tubing is not flared)
221-60	Coiled 3/8" O.D. PFA tubing (stretches to 8 ft. long, tubing is not flared)
221-68	Coiled 3/8" O.D. FEP tubing with 1/8" recirculation tubing preassembled
221-69	Coiled 3/8" O.D. PFA tubing with 1/8" recirculation tubing preassembled

Note: Additional fittings are available. Consult the factory for part numbers.

Replacement Parts for DI Water Spray Gun

Part Number	Description
600037	Replacement cap - Natural
600037BL	Replacement cap - Blue
600037OR	Replacement cap - Orange
500121	Replacement nozzle
421-06	Repair kit, "421 Series" gun, all high purity PFA material Repair kit includes piston, pin-trigger front and rear diaphragms of high purity PFA material, spring, spool. (Tool required)
213-80	Repair tool to access front and rear diaphragm of gun

Performance Data

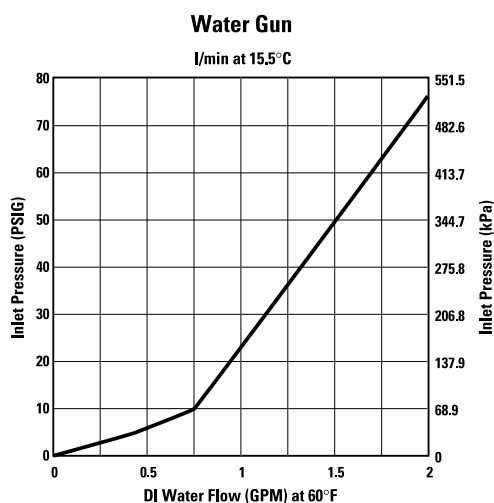

Spray Pattern of DI Water Gun

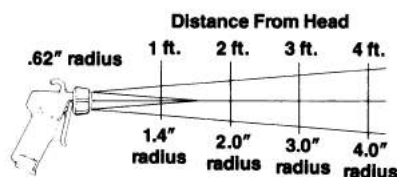

Spray Gun



Spray Pattern of Gun

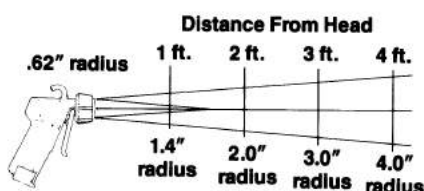

Gun

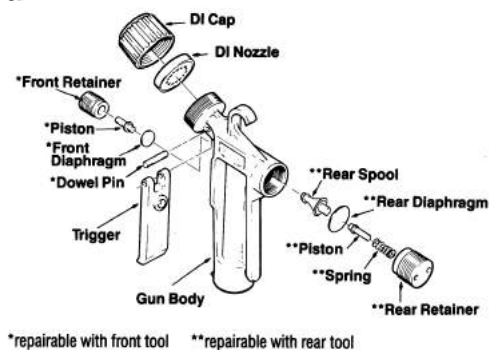

Connection Options

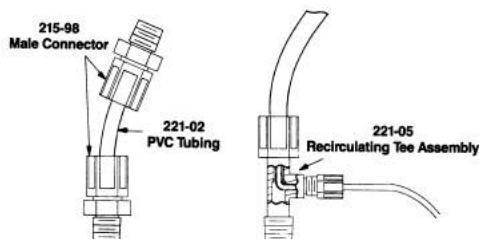

Dispense Cap



Ordering Information

4 2 1 - X 2 - X 1

Cap Color

- 1 = Natural
- 2 = Blue
- 3 = Orange

Type of Inlet Connection

- 2 = 1/2" FNPT Inlet
- 3 = 1/4" FNPT Inlet

Part

Number

Description

- | | |
|--------|---|
| 421-57 | Complete DI Water Gun Kit
Contains 1/4" NPT gun, recirculating tee,
male connector, 8 foot length FEP 1/2" O.D. tubing. |
|--------|---|

Accessories for Spray Gun

Part

Number

Description

- | | |
|---------|--|
| 221-02 | Clear reinforced PVC tubing 1/2" O.D. 8 foot length.
(Required for connection are two 215-98 fittings or one 215-98 and one 221-05 recirculating tee.) |
| 215-98 | Male Connector for 1/2" PVC tubing to 1/4" NPT inlet on gun. |
| 221-05 | Recirculating tee assembly allows for continuous flow of DI water through the gun preventing possible bacteria formation that may occur in stagnant water. Consists of 10 feet of 1/8" O.D. tubing and one 215-55 fitting. |
| 215-55 | Recirculating tee fitting ONLY (1/4" MNPT x 1/8" compression x 1/2" compression) |
| 603-864 | Dispense Cap (single hole) |

Replacement Parts

Part

Number

Description

- | | |
|----------|--|
| 600037 | Replacement cap - Natural |
| 600037BL | Replacement cap - Blue |
| 600037OR | Replacement cap - Orange |
| 500121 | Replacement nozzle |
| 421-06 | Repair kit, "421 Series" gun, all high purity PFA material. Repair kit includes piston, pin-trigger, front and rear diaphragms of high purity PFA material, spring, spool. (Tool required) |
| 213-80 | Repair tool to access front and rear diaphragm of gun. |

See page 430 for Flaretek® fitting connection.

Specifications

Maximum pressure:	80 PSIG (552 kPa)
Orifice:	3/16" (4.8 mm)
Connection:	1/4" or 1/2" FNPT
Materials:	All wetted parts are high purity PFA.

Nitrogen Spray Gun



Part Number

421 - 42 - X1

Nozzle Color

- 1 = Natural
- 2 = Blue
- 3 = Orange

Accessories for Nitrogen Spray Gun

Part

Number	Description
221-01	Replacement filter, .5 micron PTFE membrane in polyethylene housing.
221-08	Replacement filter, .22 micron PTFE membrane in polyethylene housing.
221-04	Tube/Fitting Assembly to hook up nitrogen gun includes 8 foot length 1/4" O.D. FEP tubing and two C4-4N fittings (1/4" tube to 1/4" MNPT) of PFA.

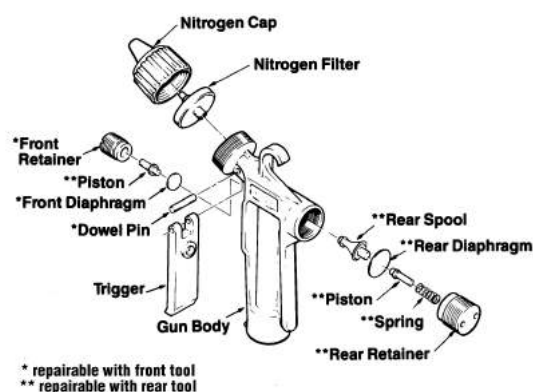

Replacement Parts

Part

Number	Description
600082	Replacement cap/nozzle - Natural
600082BL	Replacement cap/nozzle - Blue
600082OR	Replacement cap/nozzle - Orange
421-07	Repair kit, "421 Series" gun, all high purity PFA material. Repair kit includes piston, pin-trigger, front and rear diaphragms of high purity PFA material, spring, spool. (Tool required)
213-80	Repair tool to access front and rear diaphragm of gun.

Performance Data

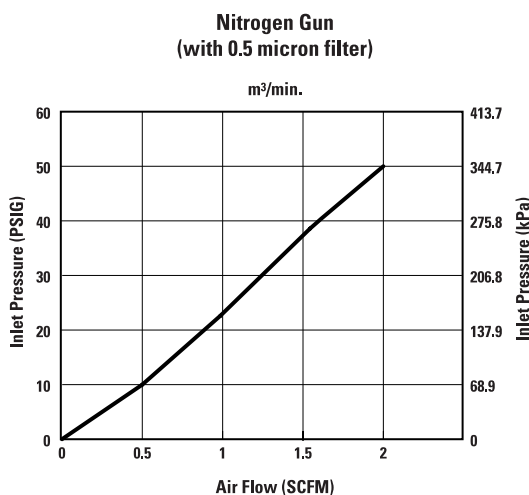

Specifications

Maximum pressure:	75 PSIG (517 kPa)
Orifice:	3/16" (4.8 mm)
Connection:	1/4" FNPT
Filter:	0.5 micron PTFE membrane
Materials:	All wetted parts PFA, PTFE and polyethylene. Nitrogen cap/nozzle prevents pressure build-up if outlet is blocked.